

Screeded Floors Underfloor Heating

Staples

Overview

Product

Basic system for placing/fixing 15mm Barrier pipe.

Application

Fixing UFH pipe to rigid insulation panels on a solid floor slab before screeding.

Features and Benefits

Product

- ⦿ Staples to fix pipe in position on rigid insulation
- ⦿ Lowest material cost

Design/Installation

- ⦿ Pipe spacing/layout at installer's discretion

NOTE: 200mm centres normally offer the best balance of performance and cost.

- ⦿ Installer marks top of insulation to indicate pipe positioning/spacing
- ⦿ Full flexibility to set pipe layout and spacing to suit specific project needs
- ⦿ Independent choice of insulation panels to suit thermal and acoustic properties as required
- ⦿ Suits irregularly shaped floor areas
- ⦿ Staple gun available to installer: enables pipe fixing from standing position

System Performance

- ⦿ Heat output subject to pipe spacing and layout consistency, see heat output tables in underfloor heating product guide

System Construction

1. Edge expansion foam: with adhesive backing and gaiter to prevent screed ingress under insulation
2. Sand/cement or proprietary screed
3. 15mm Barrier pipe
4. Staples
5. Insulation panels: independent choice to suit required thermal/acoustic performance
6. Level solid sub-floor

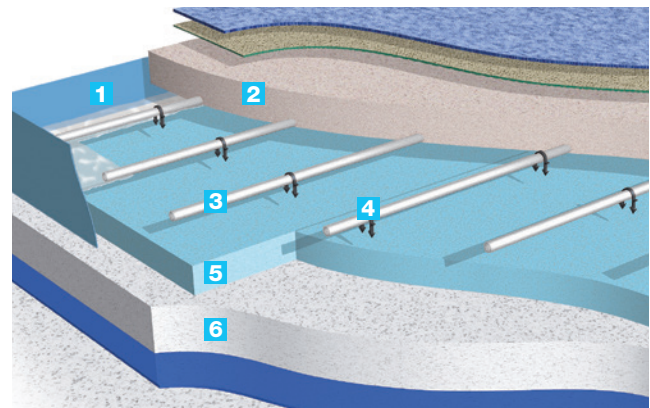

Section view

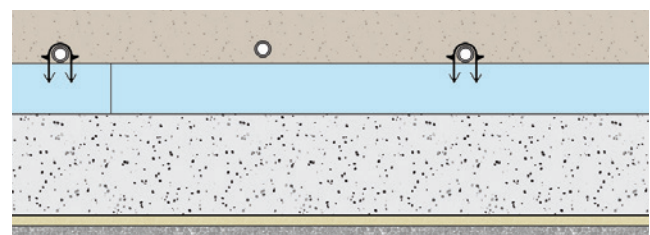

Technical Information

Base Material:	Nylon 6,6 (Polyamide)
Staple Length:	40mm and 60mm
Staple Frequency:	≈ 3 Per Metre of Pipe
Straights:	500mm Intervals
Bends:	3 (Start-Middle-End)
Supported Pipe Sizes:	12-16mm
Pipe Spacing:	Free Form (Typically 200mm)
Permissible Pipe Deviation:	Specified by EN1264-4
Vertical:	5mm
Horizontal:	+/- 10mm (Off Specified Spacing)

Transitional Areas

Where pipes need to be supported and secured for run up wall to manifold: Curved Pipe Supports and Clamps are available (see underfloor heating product guide).